

# DEKTITE® EZi-Seal™

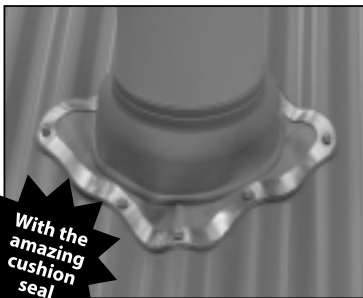

## Forget the silicone -just screw it down

Dektite® EZi-Seal™ features a revolutionary closed-cell foam gasket which is non-absorbant and non-porous. It hugs the roof line to provide a watertight seal without the need for silicone.



With the amazing cushion seal

### Dektite® EZi-Seal™ Hang-sell

Dektite® EZi-Seal™ products are now available in individual hang-sell packs with printed instructions and fasteners included.



#### 100% Waterproof

Seals completely waterproof at only 40% compression



#### Seals on wet or oily surfaces

No need to clean or prepare the surface



#### Safer on the roof

No silicone means no slippery surface or mess



#### No worries on polycarbonate

The foam base will not react with polycarbonate roofing



#### Meets the toughest conditions

UV, ozone and temperature resistant foam.



#### EPDM

Perfect for approved flues

## EZi-Seal™ Easy Selection Guide

CODE	PIPE mm	BASE mm	PITCH	COLOUR
EZ0-35	0-35	99 x 99	0 - 60°	BLACK EPDM
EZ5-55	5-55	137 x 137	0 - 45°	
EZ50-70	50-70	178 x 178	0 - 45°	
EZ5-120	5-120	218 x 218	0 - 45°	
EZ110-170	110-170	284 x 284	0 - 45°	
EZ160220	160-220	365 x 365	0 - 45°	
EZ160-300	160-300	453 x 453	0 - 45°	
EZ290-440	290-440	581 x 581	0 - 45°	

EZi-Seal carded add C before the size (ie EZC5-55)

## INSTALLATION INSTRUCTIONS

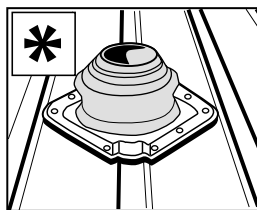

For effective drainage always fit the Dektite® EZi-Seal™ on the diamond or bias.

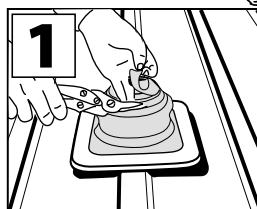
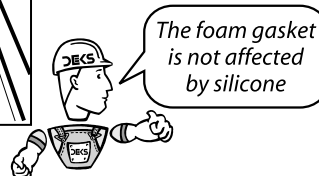

1 Cut a neat hole in roofing sheet with minimum clearance for pipe and insert pipe through hole. Trim the cone to suit pipe size using sharp tin snips.

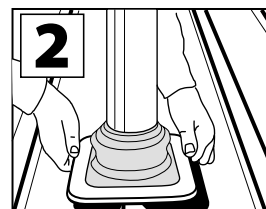

2 Slide Dektite® flashing down over pipe. Lubricating the pipe with water allows the pipe to slide snugly into position.

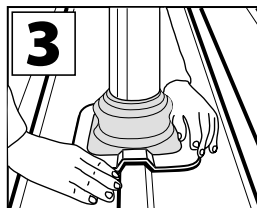

3 Press base to the roof profile by hand, smooth out any awkward creases. Don't fully extend to allow for vibration.

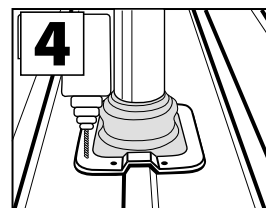

4 Fasten using sealed rivets or washers. Fit fasteners progressively outward in opposing pairs to avoid gaps.

Dektite® EZi-Seal™ seals by compression, so ensure fasteners are evenly distributed (approx. every 40mm) around base. It is also essential that fasteners are placed in any valleys created when product forms around a roof ridge.

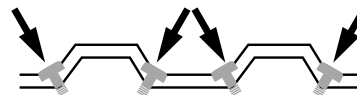

### FOR BEST RESULTS:

- Fix fasteners at points where base has creased to conform to roof profile.
- Use 10 x 16 Hex head self-drilling fasteners.
- After screw-fixing the base, flatten the aluminium between the fixings to compress the foam.
- Always install a fixing into the corners of the profile to fully seal against the sheet.
- Make sure the foam is compressed by at least 40% all the way round to ensure an effective seal.