

# FLASHING SYSTEMS

Selection and  
Installation Handbook

ISSUE  
**08**



- Longrun Metal Roofs
- Concrete, Slate and Tile roofs
- Flues
- Pipes
- Ridges
- Apron Flashings
- Hip Flashings
- Damp Proof Course
- Silicone
- Tape



**Got a question? Please contact us using details below.**

**Email:** [info@dlmwallace.co.nz](mailto:info@dlmwallace.co.nz) **Web:** [www.dlm.co.nz](http://www.dlm.co.nz) **Tel:** 09 622 9100

# Time and money saving answers for every flashing situation



Whatever your building and construction flashing requirements, you will find an innovative, practical answer in the DLM range of flashing systems.

The unique features and high performance of any DLM flashing system symbolises the care and attention to design detail that goes into every DLM product.

From the smallest cable penetration, through to roof, window and door flashings, or for an emergency repair in a hurry, DLM will provide the ultimate weather tight seal.

When you choose from the DLM flashing systems you will discover the advantages of doing it right, with better performance and an easier, more cost effective installation.

## Contents

<b>Helpful Hints</b>	Page 1
<b>Dektite Pipe Flashing Warranties</b>	Page 1
<b>Dektite</b> Design features	Page 2
<b>Dektite Premium</b> The versatile solution	Page 3-4
<b>Dektite Premium Solar Flashing</b> Perfect for flashing pipes and cables on any roof type	Page 5
<b>Dektite Shingle Flashings</b> Perfect for flashing pipes and cables on shingle roofs	Page 6
<b>Dektite Combo</b> Flash over or around. A standard Dektite and Retrofit all in one	Page 7-8
<b>Dektite Flatseal</b>	Page 9
<b>Dektite Soaker</b> The perfect flashing for all tray roofs	Page 9
<b>Dektite Retrofit Soaker</b> Designed to flash where access to installation is restricted	Page 10
<b>Dektite Retrofit</b> When it has to flash around and not over	Page 11
<b>Acrylead Tile Flash</b> For tiled and slate roofs	Page 12
<b>Dektite Aluminium</b> The best solution for stone chip and pressed metal tiles	Page 13
<b>Dekform</b> Lead free alternative to suit all tiled roof flashing applications	Page 14
<b>Dekstrip Flashing</b> With the amazing stretch edge	Page 15
<b>Fast Flash</b> Self adhesive and very workable lead free flashing	Page 16
<b>Perform</b> Flexible lead free roof flashing	Page 17
<b>Silicone Sealants</b>	Page 18
<b>Top Hat Roof Penetration Kit</b> For use with air conditioning units, heat pumps & solar panels	Page 19
<b>Sheet Lead and Acrylead</b> Time proven reliability	Page 20
<b>Plascourse DPC</b> An effective moisture barrier	Page 21
<b>Malthoid</b> Damp proof course	Page 21
<b>FLASHGUARD</b> The superior edge flashing	Page 22-23
<b>Specialist Tapes</b>	Page 24
DANCO Flashband 820/822 Flashtapes	Page 24
DANCO 830 Pure Aluminium Foil Tape	Page 24
Stop Leak Flashing Tape	Page 25
Leak Seal Tape	Page 25
<b>Duram</b> Coatings and waterproof membranes	Page 26

# Helpful Hints

## Dektites

- ✓ When cutting do not use a knife. Sharp tin snips will provide the smoothest finish.
- ✓ Always cut where sizes are indicated. Incorrect point of cutting may result in poor fit.
- ✓ Hand form aluminium edge before fastening.
- ✓ Fasten from vertical centre to outside.
- ✓ When pulling the Dektite down a pipe, lubricate the pipe with water first.

## Retrofits and Combos

- ✓ Do not overcrimp seam.
- ✓ For pipes over 100mm diameter use a stainless steel support clip (hose clamp) if desired.

## General Points – Applicable to all Deks flashing products

- ✓ Always ensure that a liberal amount of neutral cure 100% silicone sealant (roof and gutter approved) is applied **UNDER** any perimeter aluminium-backed edge.
- ✓ **Seamed Pipes:** When flashing a metal flue that has an exposed seam, using a neutral cure 100% silicone sealant (roof and gutter approved) seal the seam from underside of the cowl to the top of Dektite cone.
- ✓ Where multiple skin flues are used, EPDM Dektite are appropriate.
- ✓ Under **NO** circumstances should any Dektite product be used on an unapproved (**i.e. single skin**) flue discharging from a wood combustion appliance.
- ✓ Overstretching of EPDM compound products can lead to shortened life expectancy.
- ✓ Please note that the outside temperature of the pipe is usually significantly lower to the exit temperature of the appliance.

# Dektite Pipe Flashing Warranties

This warranty on Dektite Pipe Flashing is given by Consolidated Alloys (NZ) Ltd 55 Maurice Road, Penrose Auckland, New Zealand for the periods and under the terms and conditions listed below.

1. DLM warrants that all Dektite pipe flashings will perform in accordance with our published specifications and will be free from defects in material and workmanship for a maximum period of 20 years, commencing from the date of delivery to end user.

Under this warranty DLM will, at its option, repair or replace any defective Products. Any claim should be made in writing within 60 days following the discovery of any defect. DLM shall not be liable for any costs incurred in the removal of defective items or installation of replacement items nor cost of freight and other associated charges.

2. This warranty shall not apply where:-

- (a) the Product has not been installed in strict accordance with our published recommendations;
- (b) the Product has been installed in an area which has been exposed at any time during the warranty period to corrosive

conditions including but not limited to, corrosive chemicals, ash, fumes or condensates or harmful substance generated within or about the building(s) or fixture(s) to which the Product has been applied;

(c) any damage to the Product has been caused as a result of the negligence or misuse of the Product by the claimant.

(d) any modification to the specification of the Product has been made, save and except where any modification is reasonably necessary in adopting the Product to size.

(f) defects are a result of acts of God or other external forces, including but not limited to, failure to provide free drainage of water from around the areas in which the Product has been installed.

3. To the extent permitted by law, this warranty is given in lieu of all other warranties, express or implied, including any warranty of merchantability or fitness for a particular purpose. Where so permitted, the remedies stated herein are exclusive remedies and DLM shall not be responsible for any indirect, consequential or incidental damages or further loss of any kind whatsoever except as expressly provided by in this Warranty.

# Dektite

## Design features



### Flexible Cone Sleeve

Dektite cone shape eliminates seal breakdown due to vibration or expansion and contraction, while isolation of pipe from sheeting dampens noise levels.

### Stress Isolation Points

Unique to Dektite, two flexible shoulders absorb distortion and stop transfer of stresses from base to cone, as unit is formed over roofing profile.

### Bonded Aluminium Flange

Corrosion resistant, malleable flange, evenly distributes fastening pressure and allows ease of hand shaping on most sheet profiles.

### Integrity of Flashing Shape

Minimal distortion after installation, maintains natural flashing shape and seal around pipe, while water run-off is improved.

### UV Protection

Dektite products are resistant to ultraviolet light damage and will remain fully flexible under all conditions.

### Easily Identified Sizing

Pipe diameter rings are clearly marked on the cone sleeve (metric and imperial) for cutting to match the appropriate pipe diameter.

### Low Profile Design

Sleek, unobtrusive shape is designed to minimise silhouette on roofline, while managing to provide generous internal clearance for steep, angular installations.

### Improved Waterproofing

Designed to strengthen sealant bond and improve waterproofing, the ribbed base also has a tapered edge to improve runoff and contribute to a superior waterproof seal.

### Perfect for approved flues!

Dektite polymer flashings have been officially tested and conform to all Australian and New Zealand Standards on approved flue systems. EPDM withstands temperatures from  $-50^{\circ}\text{C}$  to  $115^{\circ}\text{C}$  and up to  $150^{\circ}\text{C}$  intermittently. Silicone withstands temperatures from  $-60^{\circ}\text{C}$  to  $200^{\circ}\text{C}$  and up to  $250^{\circ}\text{C}$  intermittently.

# Dektite Premium

## The versatile solution

- ✓ Most extensive range of Dektites for flashing penetrations 0 – 510mm, available in black and grey EPDM and silicone red for high temperatures.
- ✓ Designed to enable practically any pipe flashing operation to be carried out within minutes, simple to install and very effective.
- ✓ The low profile cone not only looks good but provides a generous internal clearance, so even the steepest roofs are handled with ease.
- ✓ Suitable for flashing pipes that penetrate wall claddings.
- ✓ Can also be used to flash square penetrations. Just add 30% to the pipe diameter and trim the cone to suit.

- ✓ EPDM withstands temperatures from -50°C to 115°C and up to 150°C intermittently.
- ✓ Silicone withstands temperatures from -60°C to 200°C and up to 250°C intermittently.



## Installation Instructions:

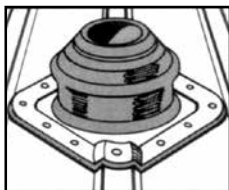

### NOTE:

For more effective drainage, always fit the Dektite on the diamond or bias. Dektites are suitable for flashing pipes that penetrate wall claddings.

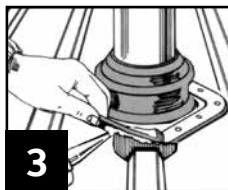

Apply a neutral cure 100% silicone sealant (roof and gutter approved) to the underside of the Dektite by turning back the flexible flange.

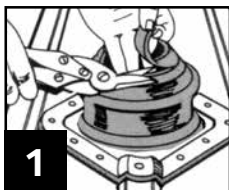

Cut a neat hole in roofing sheet with minimum clearance for pipe and insert pipe through hole. Trim the cone to suit pipe size using sharp tin snips. Where required, support cut sections of sheet with additional framing.

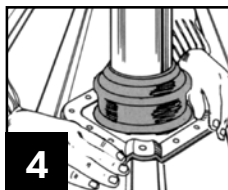

Press base to the roof profile by hand, smooth out any awkward creases. Don't fully extend to allow for vibration.

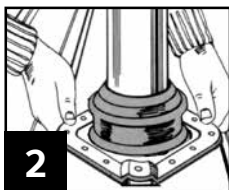

Slide Dektite flashing down over pipe. Lubricating the pipe with water allows the pipe to slide snugly into position.

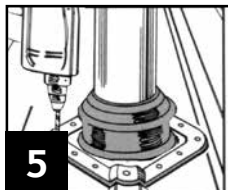

Fasten using self drilling washers or sealed rivets. Fit fasteners progressively outward in opposing pairs to avoid gaps.

# Dektite Premium

The versatile solution

CODE: BLACK EPDM	CODE: GREY EPDM	CODE: RED SILICONE	BASE (MM)	PIPE (MM)	ROOF PITCH
DFE10MB			71 x 71	0-20	Up to 60° See foot note
DFE100B	DFE100G		100 x 100	0-35	
DFE100BS*		DFE200RES	100 x 100	0-35	
DFE101B	DFE101G		139 x 139	5-55	Up to 45° See foot note
DFE101BS*		DFE201RES	139 x 139	5-55	
DFE102BA	DFE102GA	DFE202REA	181 x 181	50-70	
DFE103B	DFE103G	DFE203RE	218 x 218	5-127	
DFE104B	DFE104G	DFE204RE	279 x 279	75-175	
DFE105B	DFE105G	DFE205RE	309 x 309	100-200	
DFE106B	DFE106G	DFE206RE	363 x 363	125-230	
DFE107B	DFE107G	DFE207RE	456 x 456	150-300	
DFE108B	DFE108G	DFE208RE	495 x 495	170-355	
DFE109B	DFE109G	DFE209RE	680 x 680	230-508	

\* DFE100BS and DFE101BS both have multiple cable nipples



## Can a Dektite flash a square pipe? **YES!**

100mm Round

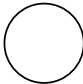

Circumference = 314mm

100mm Square



Perimeter = 400mm

**Difference = Approx. 30%**

Therefore, to suit square pipes/stanchions add 30% to the diameter of the pipe and cut accordingly.

**100mm x 30% = 130mm  
to suit a square**

NOTE: Refer to page 7 for guide to Dektite square penetrations from 20mm - 125mm.

# Dektite Premium Solar Flashings

Perfect for flashing pipes and cables on any roof type

The multi-application flashing in a highly durable EPDM or silicone, edged with a flexible aluminum band, flashes pipes and cables on all roofs. The square base fits most roof profiles.

### Dektite Premium DFE101BM

- ✓ Incorporates 12 cable nipples.
- ✓ Ideal for Solar PV installations.
- ✓ Black EPDM high UV resistant cone.



### Dektite Premium DFE100BS

- ✓ Incorporates 3 cable nipples.
- ✓ Suitable for pipes and/or cables.
- ✓ Available in black EPDM.



### Dektite Premium DFE200RES

- ✓ Versatile flashing accommodates up to 5 penetrations.
- ✓ Suitable for pipes and/or cables.
- ✓ Available red silicone.



## Solar Kit DSK200 KIT Components:

### DEKTITE FLASHING ADHESIVE (Silicone Dektites only)

Dektite Flashing Adhesive (50ml) is a one part neutral cure (non acid) engineering grade silicone adhesive. This primerless adhesive adheres to most substrates and is formulated for use with Dektite silicone flashings only. The adhesive reacts with atmospheric moisture to produce a long life seal that is resistant to UV and will remain flexible and withstands temperatures from -50°C to 165°C. Ideal for tile roofs.



### DEKTITES (2pcs)

2 x silicone Dektites  
0 - 35mm plus 2 x cable nipples.  
Red silicone will withstand constant temperatures at the roofline or -50°C to 200°C and up to 250°C intermittently.

### ROOFING SCREWS (16 pcs)

10 Gauge, 16mm, class 4, mechanically plated roofing screws. 16 screws in solar kit.

CODE	No CODE	TO FIT PIPE SIZE	ROOF PITCH
DFE100BS (BLACK EPDM)	SOLAR MINI #0	0 - 35	Up to 60° See foot note
DFE101BS (Black EPDM)	SOLAR #1	5 - 55	
DFE200RES (Silicon Red)	SOLAR MINI #0	0 - 35	
DFE201RES (Silicon Red)	SOLAR #1	5 - 55	
DFE101BM (Black EPDM)	MULTI CABLE	12 X 4-8MM	
DSK200RES (Red Silicon)	SOLAR KIT	0 - 35	
DFA050G (Grey)	ADHESIVE		
DFE050RE (Red)	ADHESIVE		

# Dektite Shingle Flashings

Perfect for flashing pipes and cables on shingle roofs

## Dektite SHR

For Shingle Roof Retrofit Applications on Electrical Masts, Re-Roofing etc.

- ✓ Pipe OD range 0-150mm (clearly marked cutting grooves).
- ✓ Available in black, made from proprietary polymer material compatible with asphalt shingles.
- ✓ Slide down the pipe without cutting, or cut along the zipper and use the clips supplied for retrofitting.
- ✓ Aluminum flange nails securely to the roof.
- ✓ Twenty year warranty. Just fit it and forget it - we've got you covered.

CODE	TO FIT PIPE SIZE	BASE SIZE	ROOF PITCH
DSR103B	0 - 150mm	380 x 380mm	10 - 45°



## Dektite SHT

- ✓ Thermoplastic hard base with elastomer collar. Compatible with asphalt shingles. No caulk, self-sealing.
- ✓ 85°C continuous heat.

CODE	TO FIT PIPE SIZE	BASE SIZE	ROOF PITCH
DST101B	32 - 40mm	330 x 235mm	Up to 45°
DST102B	50mm	330 x 235mm	Up to 45°
DST103B	75mm	380 x 285mm	Up to 45°
DST104B	100mm	405 x 305mm	Up to 45°





# Dektite Combo

Flash over or around, a standard Dektite and Retrofit all in one

- ✓ The unique cone design makes the combo range suitable for both standard and retrofit applications.
- ✓ When retrofit is required just cut and apply clips for ease of application. **Clips included.**
- ✓ Provides 10 – 20mm continuous contact with flashed pipe providing a watertight seal.
- ✓ Clear markings makes for easier cutting to pipe size.
- ✓ Size ranges – Numbers 1 – 10 (5 – 750mm)
- ✓ Available in black EPDM.
- ✓ Just fit it and forget it – we've got you covered.
- ✓ EPDM withstands temperatures from -50°C to 115°C and up to 150°C intermittently.



## Combo Selection Guide

CODE	DESCRIPTION	PIPE (MM)	BASE (MM)	ROOF PITCH
DC101BC	Dektite Combo #1	5-60	139 x 139	Up to 40° See foot note
DC102BC	Dektite Combo #2	45-85	177 x 177	
DC103BC	Dektite Combo #3	5-127	221 x 221	
DC104BC	Dektite Combo #4	75-175	285 x 285	
DC105BC	Dektite Combo #5	108-190	366 x 366	
DC106BC	Dektite Combo #6	125-230	366 x 366	
DC107BC	Dektite Combo #7	150-280	454 x 454	
DC108BC	Dektite Combo #8	175-330	454 x 454	
DC109BC	Dektite Combo #9	240-508	705 x 705	
DC110BC	Dektite Combo #10	400-750	965 X 965	

## Combo Square Selection Guide

CODE	DESCRIPTION	PIPE (MM)	BASE (MM)	ROOF PITCH
DCS103BC	Dektite Combo Square	20-125	221 x 221	Up to 40°

# Dektite Combo

Flash over or around, a standard Dektite and Retrofit all in one

## Installation Instructions

### Standard Application

- 1 Trim the cone to suit pipe size using sharp tin snips.
- 2 Slide down pipe using water as a lubricant.
- 3 Apply a liberal bead of silicone sealant on underside of flexible aluminium base.
- 4 Press base to the roof profile by hand. Smooth out any awkward creases. Don't fully extend to allow for vibration.
- 5 Fasten using self drilling washered screws or sealed rivets.

### Retrofit Application

- 1 Trim cone to suit pipe size then cut seam and aluminium base using sharp tin snips.
- 2 Apply a liberal bead of neutral cure 100% silicone sealant (roof and gutter approved) to one side of the cut seam.
- 3 With seam in downstream position wrap cone around pipe and engage 1st double clip at top of seam using multigrips.
- 4 Engage remaining clips working down from top of cone to base making sure that you do not over crimp.
- 5 Apply liberal bead of neutral cure 100% silicone sealant (roof and gutter approved) to underside of Dektite Combo and shape to roof by hand. Screw down using self drilling washered screws or sealed rivets.
- 6 Fasten flashing down by placing a fastener either side of seam first then secure rest of base working outwards in opposing pairs.
- 7 Apply sealant to top of base closure and any other potential leak areas.

# Dektite Flatseal

For flat and low pitch roofs

- ✓ For flat and low pitch roofs with single ply or bitumen coverings.
- ✓ No special tools or fittings are needed.
- ✓ Flatseal EPDM snaps tight to pipe without clips.
- ✓ Seals to roof with hot or cold liquid bitumen.
- ✓ Black EPDM for maximum UV and ozone resistance.



CODE	BASE (MM)	PIPE (MM)	COLOUR
FS25-175	345	25-175	BLACK (EPDM)



# Dektite Soaker

## The perfect flashing for all tray roofs

- ✓ The large base of the Dektite Soaker dramatically reduces rainwater back up on very low or very high roof pitches and deep ribbed roofing profiles.
- ✓ Dektite Soakers are ready to use straight from the box.
- ✓ Engineered to eliminate damming.
- ✓ Faster to flash than old fashioned methods.
- ✓ The unique corrosion resistant aluminium flange is ideal for low pitch and deep profile roofs, providing a positive leak-proof seal.
- ✓ EPDM withstands temperatures from -50°C to 115°C and up to 150°C intermittently.

### IMPORTANT:

**For any pitch above 40° do not cut below the first three sizing ribs on the 603, 605 and 606**



CODE	BASE (MM)	PIPE (MM)	ROOF PITCH	PIPE (MM)	ROOF PITCH
DF 602	410 x 360	75-160	Up to 60°		
DF 603	485 x 460	114-165	Up to 60°	165-255	Up to 40°
DF 605	708 x 635	250-358	Up to 60°	358-410	Up to 40°
DF 606	1006 x 905	380-470	Up to 60°	470-610	Up to 40°

## Installation Instructions:

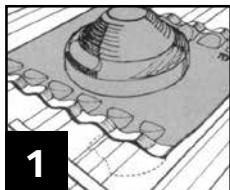

1 Mark position of pipe on roofing sheet, centre Dektite Soaker over mark ensuring word "top" is towards highest part of roof, and form Dektite Soaker flanges to roof profile.

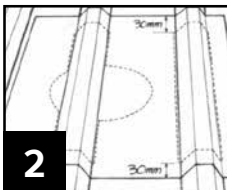

2 Mark ribs or corrugations to be removed to allow adequate drainage around cone. Allow at least 30mm all round to fasten Dektite Soaker's aluminium strips to roofing sheet.



3 Cut out marked portions of roof, filing away sharp edges and install pipe securely in place. Where required, support cut sections of sheet with additional framing to support base.

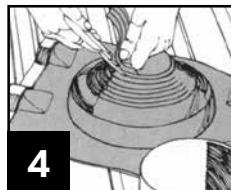

4 Trim Dektite Soaker cone to suit pipe size with sharp tin snips and slide down pipe using water as lubricant.

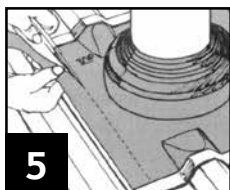

5 Form Dektite Soaker base into contours of roofing sheet, positioning loose strips on either side of cone in best position to ensure drainage of pan or tray. Trim excess EPDM from outside of loose strips. Trimming should be considered prior to cutting of the roof sheet.



6 Apply a generous bead of neutral cure 100% silicone sealant (roof and gutter approved) to the underside of Dektite Soaker base along entire perimeter.

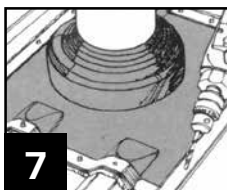

7 Fasten flashing to roof using washers or self-drilling screws or sealed rivets, ensuring Dektite Soaker forms flat trough for water run-off. Fix integral aluminium strips from centre outwards before attaching loose strips provided.



# Dektite Retrofit Soaker

**Designed to flash where access to installation is restricted**

- ✓ Like Dektite Retrofit, they are designed to flash where access to installation is restricted.
- ✓ The unique crimp closure mechanism makes pipe or vent flashing an elementary wrap and seal procedure requiring no soldering or special tools.
- ✓ The Dektite Retrofit Soaker will flex with the roof decking without cracking or leaking and their smooth tray area means water run-off is super efficient.
- ✓ EPDM withstands temperatures from -50°C to 115°C and up to 150°C intermittently.

## One Standard Size: for 235 - 425mm pipes

CODE	BASE (MM)	PIPE (MM)	ROOF PITCH
RFS 4	750 x 660	235-425	Up to 45°



## Installation Instructions:

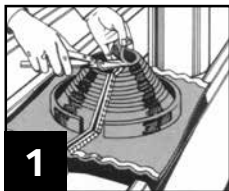

1 Measure outside pipe diameter and trim cone exactly where indicated.

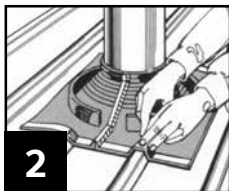

2 Mark out area where ribs of roof panel are to be removed. Where necessary support cut sections of sheet with additional roof framing.



3 With clip in down-stream position tension top of cone around pipe and engage metal teeth in opposing pockets.

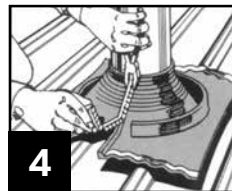

4 Crimp the top three clips with pliers. To assist in completion of crimp, place hand behind the seam for support and continue crimping. Do not overcrimp.

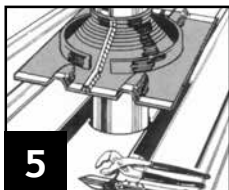

5 Form Dektite base into contours of roofing sheet, positioning loose strips on either side of cone in best position to ensure drainage of pan or tray and trim sides if necessary. Trimming should be considered prior to cutting of the roof sheet.

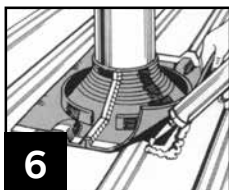

6 Apply a generous bead of neutral cure 100% silicone sealant (roof and gutter approved) to underside of Dektite base and press to contour of sheet profile.

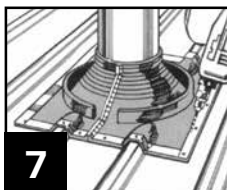

7 Fasten flashing to roof using washers self drilling screws or sealed rivets. Secure clip by placing a fastener either side of the clip. Fix integral aluminium strips from centre outwards before attaching loose strips provided.

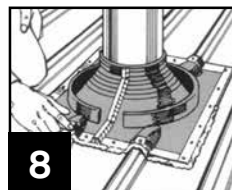

8 Apply neutral cure 100% silicone sealant (roof and gutter approved) to the top of crimp closure and any other potential leak areas.

# Dektite Retrofit

When it has to flash around and not over



- ✓ Wraps around existing or difficult to access pipes, installations are a breeze.
- ✓ The built-in crimps mean no loose clips or rivets, snaps together in seconds.
- ✓ Made from quality polymer compounds, grips tight and stays tight.
- ✓ The supple aluminium base conforms like magic for easy profile moulding.
- ✓ Can also be used to flash square penetrations. Just add 30% to the pipe diameter and trim the cone to suit.
- ✓ EPDM withstands temperatures from -50°C to 115°C and up to 150°C intermittently.
- ✓ Red silicone will withstand constant temperatures at the roofline of -50°C to 200°C and up to 250°C intermittently.
- ✓ For pipes over 100mm Ø use a stainless steel support / hose clamp.



CODE: GREY EPDM	CODE: RED SILICONE	BASE (MM)	PIPE (MM)	ROOF Pitch
RF 801G	RF901	160	20-70	Up to 40° See foot note
RF 802G	RF902	273	50-185	
RF 803G	RF903	369	85-255	

## Installation Instructions:

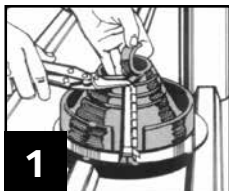

Measure outside pipe diameter and trim cone exactly where indicated.

**For square pipes add 30%.**



With clip in down-stream position, tension top of cone around pipe and engage metal teeth in opposing pockets.



To assist in locating clip into pocket, place hand behind the seam. Fasten clip with pliers or multi-grips, working from top to base. **Do not overcrimp.**

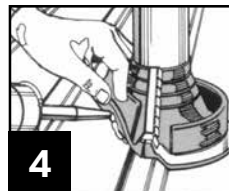

Press the Dektite base to contour of roof sheet profile, then apply a generous bead of neutral cure 100% silicone sealant (roof and gutter approved) to the underside.

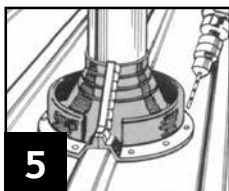

Fasten flashing with washered self drilling screws. As per diagram, secure clip by placing a fastener either side of the clip first.

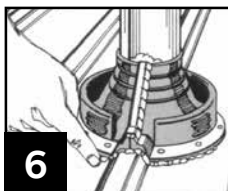

Apply sealant to top of crimp closure and any other potential leak areas.

# Acrylead Tile Flash

For tiled and slate roofs



- ✓ Acrylead offers the benefit of a thermo baked acrylic primer coating to both surfaces of the lead apron, ready for finish coating to match surrounding roof or trim colours.
- ✓ Acrylead flashings comply with AS1804 and have a minimum unit mass of 17kg/m<sup>2</sup>.
- ✓ The potential for lead oxides to leach from the apron and cause staining is now virtually eliminated.
- ✓ EPDM withstands temperatures from -50°C to 115°C and up to 150°C intermittently.
- ✓ Easy to install - no messy sealants required or sticky backing used.

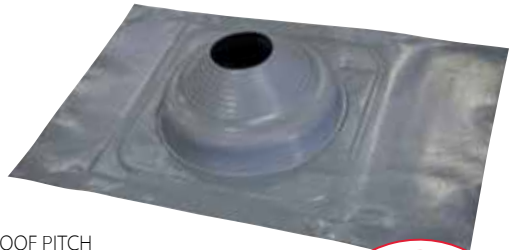

CODE	BASE (MM)	PIPE (MM)	ROOF PITCH
TFL0-35	300 x 600	0-35	Up to 45°
TFL0-35 TWIN	300 x 600	0-35 x 2	Up to 45°
TFL5-55	300 x 600	5-55	Up to 45°
TFL50-70	300 x 600	50-70	Up to 45°
TFL5-127	400 x 600	5-127	Up to 45°
TFL75-175	450 x 600	75-175	Up to 45°
TFL150-300	600 x 900	150-300	Up to 45°



## Installation Instructions for Lead and Aluminium Flashing:



Trim Tileflash cone to suit pipe size.



After first lubricating the flue with water, slide Tileflash down to tile level.

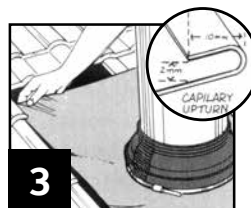

Flatten the Acrylead and form an anti-cappillary fold. Then place the upper edge of the base underneath the tiles up stream.

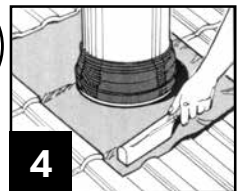

Finally, dress the apron to the surrounding tile area.



# Dektite Aluminium

## The best solution for stone chip and pressed metal tiles

- ✓ The base is 99.9% pure grade aluminium making it strong, malleable and easy to install.
- ✓ Environmentally friendly, ideal where potable water is collected.
- ✓ The best solution for stone chip and pressed metal tiles.
- ✓ EPDM withstands temperatures from -50°C to 115°C and up to 150°C intermittently.

CODE	BASE (MM)	PIPE (MM)	ROOF PITCH
TFA 12-70	500 x 600	12-70	Up to 45°
TFA 50-170	600 x 600	50-170	Up to 45°
TFA 110-200	764 x 764	110-200	Up to 45°
TFA 160-300	600 X 900	160-300	Up to 45°
TFA 300-450	965 x 965	300-450	Up to 45°



## Installation Instructions:

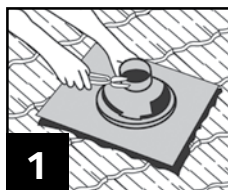

Trim Dektite cone to suit pipe size using sharp tin snips.

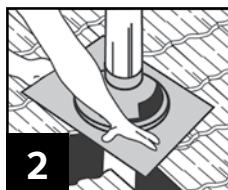

After lubricating the flue with water, slide Dektite down to the tile level.

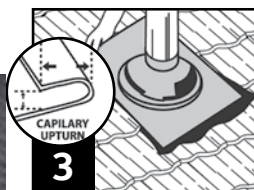

Form an anti-capillary fold then place upper edge of base under up-stream tiles.

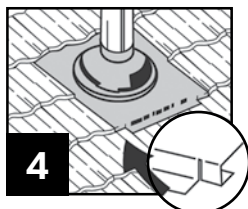

Dress base to profile, cut tabs on the bottom corners and fold under to stop wind lift.

# Dekform

## Lead free alternative to suit all tiled roof flashing applications

Dekform is the lead free alternative of the future. Designed to suit all tiled roof flashing applications. A great product choice when rain water harvesting is in use. Keep your water clean from lead contamination when diverting water from roof tank.

- ✓ Environmentally friendly. No leaching of chemical or colouring agents.
- ✓ Light weight. Dekform is 1/3 the weight of lead.
- ✓ Great form stability. Easily applied and shaped to required roof profile.
- ✓ Available in Grey EPDM.
- ✓ EPDM will withstand constant temperatures at the roofline of -50°C to 115°C and up to 150°C intermittently.
- ✓ Easy painting. Able to be painted with 100% Acrylic Low Sheen exterior paint.
- ✓ Twenty year warranty. Just fit it and forget it – we’ve got you covered.



Code (Grey)	Pipe OD (mm)	Apron Sheet Size (mm)	Pitch	Carton Qty
100	0-35	410 x 490	Up to 40°	5
101	12-70	410 x 490	Up to 40°	5
102	50-70	600 x 450	Up to 40°	5
103	50-170	600 x 450	Up to 40°	5
108	175-330	850 x 550	Up to 40°	5

### Installation Instructions:

Use PERFORM hammer to dress down leading edges.  
When installing Dekform we recommend ZBOND Metal and Masonry silicone V4 for adhesion.  
If painting is required, we recommend 100% Acrylic Low Sheen exterior paint for the Dekform base.  
If painting is required for the Dektite the surface needs to be weathered for 3 weeks in its installed position then washed with warm water and prepared by coating with a small amount of mild solvent.  
Then apply 100% Acrylic Low Sheen exterior paint.

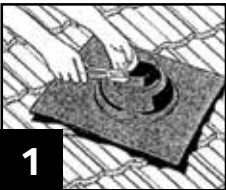

Trim the cone to suit pipe size using sharp tin snips.

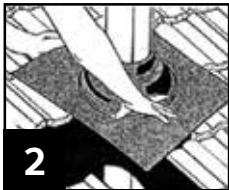

Slide down pipe using water as a lubricant.

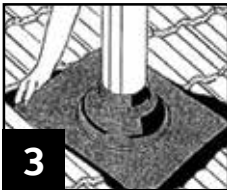

Flatten the Dekform sheet and then place upper edge of base underneath the tiles to form a return edge.

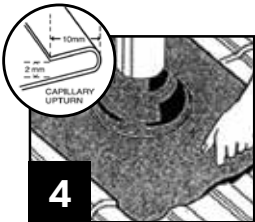

Hand dress the apron for a professional finish with a perform hammer.  
Lift sheet and apply spot adhesion technique using Z Bond Metal and Masonry Silicone V4.



# Dekstrip Flashing

With the amazing stretch edge

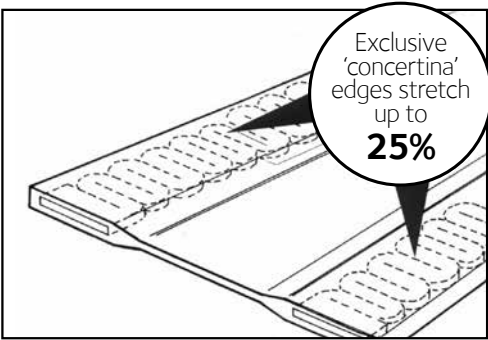
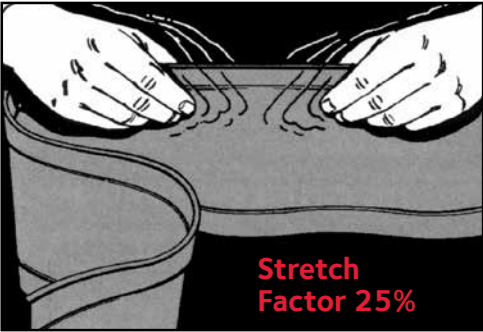

- ✓ The Dekstrip edges contain an expanding aluminium strip (in concertina form) totally encased by the EPDM flashing.
- ✓ Dekstrip can be stretched and formed around most roof profiles and maintain that shape.
- ✓ Typical applications include bullnosing, where two different profiles intersect, curved parapet flashing, expansion joints in gutters, change of pitch and large round pipe penetrations.
- ✓ Fastening is done through the aluminium strip using suitable fasteners with a minimum 10mm head. In case of rivets use a 10mm washer under head.
- ✓ EPDM based thermoplastic elastomer (TPE) will withstand temperatures from -50°C to 115°C and up to 150°C intermittently.
- ✓ Dekstrip can be painted (contact DLM for technical advice).

## Large Round Pipes

- 1 Mark a line on the pipe, 156mm above the roof. Take this mark from the valley. Circle the pipe.
- 2 Fasten Dekstrip at this line, after applying neutral cure 100% silicone sealant (roof and gutter approved). Overlap ends by 50mm.
- 3 Stretch the entire unfastened bottom edge.
- 4 Seal and fasten bottom edge, allowing same overlap at bottom as at top – suggest valley fixing.

All listed measurements are for 235mm wide strip flash. If using other widths use a ratio of 2/3 up the pipe 1/3 over the roof profile.

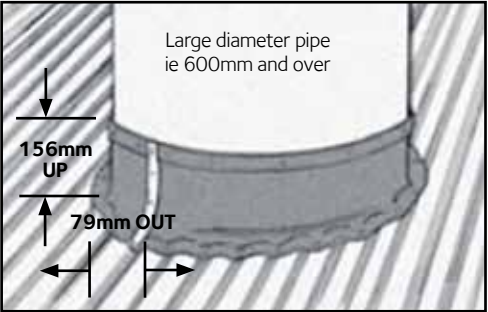

## Expansion Joints

The flexibility of Dekstrip makes it ideal for joining box guttering. No problems with movement or leaking.

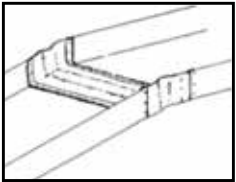

CODE	LENGTH (M)	WIDTH (MM)	MATERIAL
DS3-235	3.1	235	EPDM based grey Thermoplastic Electomer (TPE)
DS10-180	10	180	
DS10-235	10	235	
DS10-305	10	305	
DS23-180	23	180	Price and availability on application
DS23-235	23	235	
DS23-305	23	305	
DS15-450	15	450	

# Fast Flash

Self adhesive and very workable lead free flashing



- ✓ Easy to install being light weight, easy to trim and fully self-adhesive.
- ✓ Slower set adhesive allows time for repositioning.
- ✓ Flexible, malleable and expandable making Fast Flash very workable and able to dress well to all profiles.
- ✓ Product range includes rolls in three standard sizes in grey or black.
- ✓ Environmentally friendly aluminium stretch netting cast in polymer rubber.
- ✓ Other sizes and colours available on request.



## Fast Flash - quick weatherproof flashing

Fast Flash consists of aluminium expandable mesh cast in environmentally friendly polymer rubber. Fast Flash is self-adhesive on the reverse and protected by cover foil that is removed before installation. Fast Flash is available in rolls in two standard sizes and comes in grey or black.

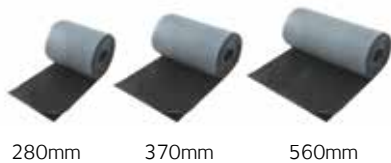

Code	LENGTH (M)	WIDTH (MM)	WEIGHT (KG)	COLOUR
FFR5-280G FFR5-280B	5	280	4.7	GREY BLACK
FFR5-370G FFR5-370B	5	370	5.9	GREY BLACK
FFR5-560B FFR5-560G	5	560	9.2	GREY BLACK

## Self-adhesive flashing

Fast Flash is ideal for a quick and secure flashing solution. Fast Flash can be installed on roofs with a slope of minimum 10° and on almost all roof materials. Fast Flash is environmentally friendly and easy to install as the reverse is self-adhesive, as well as being flexible and very workable.

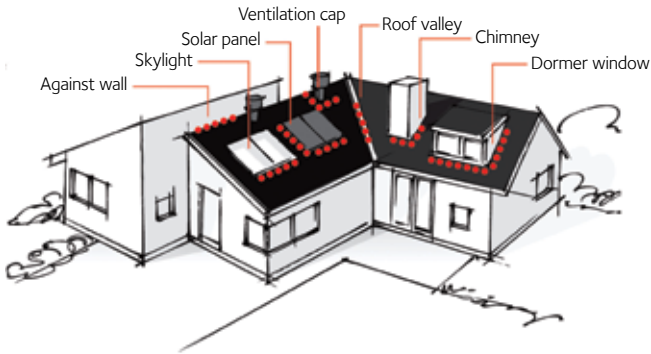

# Perform

## Flexible lead free roof flashing



- ✓ Environmentally friendly with no leaching of chemical or colouring agents.
- ✓ Perform is light weight being 1/3 the weight of lead.
- ✓ Great form stability for fast and easy mounting
- ✓ Range of rolls in various sizes are available in Grey and Black.



Stretching ability:

60% lengthwise and  
20% breadthwise

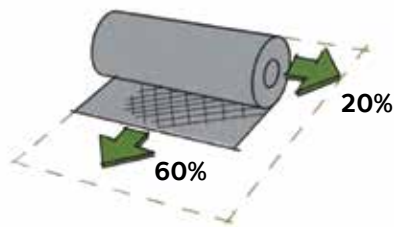

### Rolls

Code	LENGTH (M)	WIDTH (MM)	WEIGHT (KG)
PFR4-300G	4	300	4.32
PFR4-300B	4	300	4.32
PFR4-450G	4	450	6.48
PFR4-450B	4	450	6.48
PFR4-600G	4	600	8.64
PFR4-600B	4	600	8.64

### Important

- Remember to place flashing material correctly according to the actual need for stretching ability.
- Cut the flashing using a trade knife or sheet metal shears.
- When pre-fixing and shaping joints are required, use adhesive if deemed necessary.
- Use the Perform hammer to dress down leading edges.
- If painting is required, we recommend 100% Acrylic Low Sheen exterior paint.
- When lapping joints, 150mm overlap is recommended.
- Perform has the ability to expand and contract, thus allowing minimal joints.

### Installation Information

- 1 Perform flexible flashing is fixed easily and fast. The light weight and excellent stretching properties ensure simple handling and shaping of the flashing. To obtain a perfect fit use a perform hammer.
- 2 The side with the protection film is the visible or upper side of the material. This is to prevent the flashing material from getting dirty.
- 3 By folding the bottom edge it becomes significantly stronger and the roof cover then becomes even more stable in shape.
- 4 Being self-contained, Perform flexible flashing does not require adhesives. A self contained flashing is porous/breathable and prevents formation of humidity and condensation under the area covered.
- 5 When ever deemed necessary you can make terminations against walls, roofs, valley, gutters etc. For adhesive process use Z BOND Metal & Masonry Silicone V4. Spot adhesion technique is recommended.

# Silicone Sealants



The following silicones have been trialled and have been found to provide a satisfactory bond between the EPDM and Silicone Dektites and most commonly used roofing materials.

- **OCI Professional Roof and Gutter Prosil 10, Silicone Sealant**
- Sikasil AP Multipurpose Silicone Sealant.
- Selleys Roof & Gutter Silicone Sealant.
- Bostik Findley Roof & Gutter Silicone Sealant.
- Dow Corning 791 Silicone Weatherproofing Sealant.

CODE	DESCRIPTION	BOX	COLOUR
Prosil10	All purpose neutral cure silicone	20	TRANSPARENT

- For adequate bonding all surfaces must be clean and dry.
- The base of the Dektite should be moulded by hand to form a snug fit to the roof profile.
- The Dektite should then be lifted clear and a continuous bead of neutral cure 100% silicone sealant (roof and gutter approved) applied to the whole of the ribbed underside of the Dektite. For an effective seal a 1-3mm bead of silicone is sandwiched between the two surfaces.
- Pull the Dektite down to sit snugly on the roof profile and fasten with washered screws / Hex screws. NB: Screw coatings of class 4 or 5 are required.
- Remove excess silicon and collect any swarf.

# Top Hat Roof Penetration Kit

For use with air conditioning units, heat pumps and solar panels

Top Hat Roof Kit

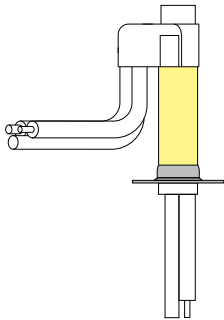

Compliant Penetration



CODE

RF PN 50
RF PN 65
RFPN80SC
RFPN110FC

SIZE (MM)

50
65
80
110



For other options on solar penetrations refer to Dektite premium solar products on page 4.

## Installation Instructions:

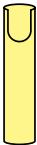

Position the PVC tube. Fix it to a batten or rafter.



Fit the Dektite flexible flashing as per the installation instructions.

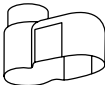

Install all pipe work and secure the cap with stainless steel self tapping screws.



For more effective drainage always fit the Dektite on the diamond as shown.

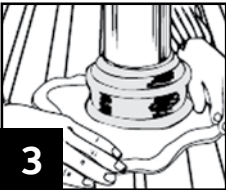

Press base to the roof profile by hand, smooth out any awkward creases. Don't fully extend to allow for vibration.

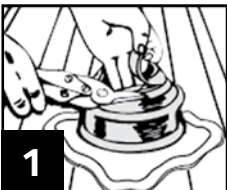

Cut a neat hole in the roofing sheet with minimum clearance for pipe and insert pipe through hole. Trim the cone to suit pipe size using sharp tin snips (where necessary, support cut sections of sheet with additional timber framing). Secure pvc pipe within ceiling space to Purlin, rafter or truss to ensure pvc pipe does not drop or move over time.

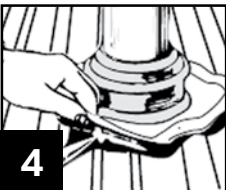

Apply a neutral cure 100% silicone sealant (roof and gutter approved) by turning back the flexible flange.

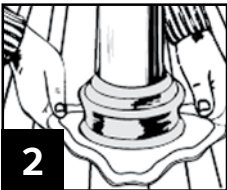

Slide Dektite flashing down over pipe. Lubricating the pipe with water allows the pipe to slide snugly into position.

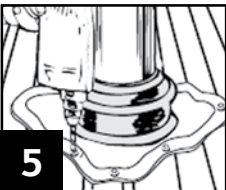

Fasten using class 4 coating washered screws. Fit fasteners progressively outward in opposing pairs.

# Sheet Lead and Acrylead

Time proven reliability



- ✓ Conforms to AS/NZ1804 – 1976
- ✓ 50 year warranty (on base metal)
- ✓ Extremely malleable
- ✓ Proven quality and performance

## DLM Sheet Lead

- Sheet Lead is the softest of all the common metals, it is extremely malleable; it is capable of being shaped to most profiles at ambient temperatures.
- Sheet lead is a tried and proven product used in the construction industry for hundreds of years, mainly used as weatherings and flashings.
- The most important feature of any well designed roof is the flashing detail. The use of Sheet Lead will ensure that quality and performance are not compromised.
- DLM Sheet Lead is ideal for applications of radiation shielding, sound proofing, chimney flashings, lead slate for pipe penetrations, apron and abutment flashing, canopies and projections, curved parapets, windows and door flashings.

## Range of thickness and weight

Weight (Kg/m <sup>2</sup> )	Nominal Thickness (mm)	Typical Uses
6	0.50	Strip edge for metal flashing, sound proofing.
12	1.0	Sound and radiation proofing.
17	1.50	Apron and cover flashings, hip and ridge flashings, pitched valley gutters, lead slates, chimney flashings and weatherings to cornices, parapets etc. Full roof cladding.
20	1.80	
25	2.25	
30	2.65	Parapet, box and tapered gutters or situations that demand extra length.
35	3.15	
40	3.55	

## Recommended maximum sizes of individual pieces of lead for all applications

Weight (Kg/m <sup>2</sup> )	Maximum Length (mm)	Maximum overall girth (mm)
17	1300	600
20	1500	750
25	2000	800
30	2250	850
35	2500	900
40	3000	1000

## DLM Acrylead

- Acrylead has a factory applied thermo baked acrylic primer coating on both sides of the sheet. The process developed by DLM inhibits the contact of water runoff with the lead and its oxides, reducing the potential of the run off staining adjacent materials, and entering ground water systems.
- Acrylead allows you to improve the look of exposed flashings by finish coating of your choice to match roof or surrounding trim colours.

## E2 / AS1 Compliance

- DLM Sheet Lead and Acrylead are the only apron/abutment flashings that can meet and exceed the 50 YEAR WARRANTY offered by Concrete, Clay, and Slate Tile manufacturers and is a must for compliance with E2/AS1.

## Standard Roll Sizes

**Sheet lead:** Both 3m and 6m rolls: 150, 300, 375mm  
3m rolls only: 450, 600, 750, 900mm

**Acrylead:** 6m rolls: 150, 300, 340, 375mm  
3m rolls only: 450, 600mm

# Plascourse DPC

## An effective moisture barrier



- ✓ Plascourse may be used as a damp course in brick or block work.
- ✓ Plascourse may be used as a concealed flashing under timber, window frames or door frames.
- ✓ Plascourse may be used when separation between different materials is required.
- ✓ Plascourse MUST NOT be used in applications where it is exposed to direct sunlight.

An effective moisture barrier for use as a dampcourse material and concealed flashing.

Plascourse is a thick, high impact low density black polyethylene strip with an embossed surface on both sides that reduces slippage in use.

Plascourse will provide an effective moisture barrier for use as a dampcourse material and also as a concealed flashing.

Plascourse is manufactured to Australian and New Zealand Standard 2904 - 1995.

Plascourse meets the test requirements for impact resistance AS/NZ 4347.6.

Plascourse is embossed both sides with dimensions between 3mm - 10mm maximum in both machine and transverse direction and it's thickness is measured in accordance with AS/NZ 4347.9.



Code	Length (m)	Width (mm)	Carton Qty
DPC50	30	50	24
DPC75	30	75	16
DPC90	30	90	12
DPC100	30	100	12
DPC140	30	140	8
DPC150	30	150	8
DPC200	30	200	4
DPC250	30	250	4
DPC300	30	300	4
DPC1000	30	1000	1

# Malthoid

## Damp proof course

- ✓ Malthoid Damp Proof Course is a Kraft saturated in multiple layers of a bituminous coating then a light sand coating.
- ✓ Malthoid may be used when separation between different materials is required.
- ✓ Malthoid may be used as a damp course in brick or block work or aluminium.
- ✓ Malthoid may be used as a flashing under timber jack studs and timber piles.

Malthoid is manufactured to meet the following provisions of the NZBC:

### NZBC Clause E2 External moisture

Malthoid Damp Proof Course satisfies the requirements of E2/AS1 Table 23, NZBC 3604 2.3(b).

### NZBC Clause B2 Durability

Malthoid Damp Proof Course will meet the durability requirements of NZBC E2/AS1 Table 1 - Damp Proof Course. Malthoid must not be exposed to extended periods of direct sunlight, or prolonged contact with chemicals or solvents.



Code	Length (m)	Width (mm)	Carton Qty
MAL50	20	50	8
MAL75	20	75	8
MAL90	20	90	6
MAL100	20	100	6
MAL150	20	150	4
MAL200	20	200	2
MAL250	20	250	2
MAL300	20	300	2
MAL1000	20	1000	1



# FLASHGUARD

## The original edge flashing

### ✓ EXTREMELY MALLEABLE

Flashguard is so easy to install, it can be dressed down using finger pressure only, so there is no need for special tools. There is no need for hammering into roof profile, no need for cutting or forcing into shape and hence no risk of scratching, denting or paint damage to the roof.

### ✓ VERY QUICK TO INSTALL

Because of the ease of fitting Flashguard, reduced installation time will result in major savings in labour costs.

### ✓ COLOUR MATCHED

Flashguard is made in over 40 colours available to match the many colours available from metal roof manufacturing suppliers.

### ✓ WEATHERPROOF

The special backing provides a weather sealing membrane with excellent elastic characteristics and resistance to moisture. Flashguard perfectly hugs the contour of the roof profile, preventing birds from gaining access.

### ✓ COMPATIBLE

Compatible with Zinalume®, aluminium and galvanised steel roofing materials, pressed metal tiles and long run metal roofs.

### ✓ POTABLE WATER

Flashguard is approved for installation when collecting potable water off the roof structure.

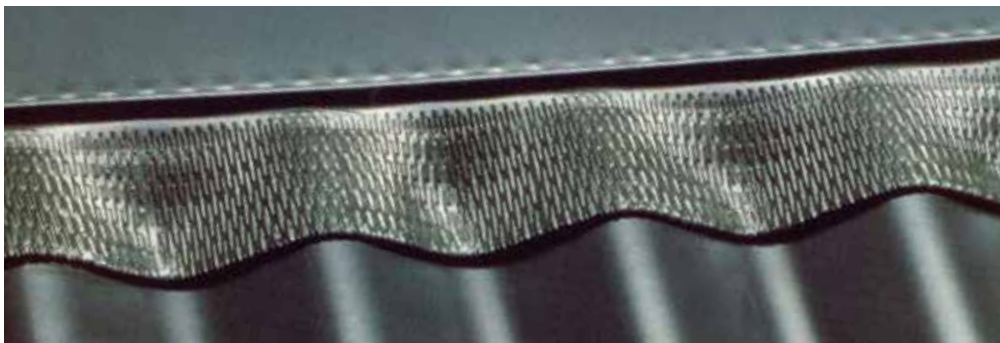

- ✓ Proven 20 years in the field.
- ✓ Codemark certification.



- ✓ Allows passive ventilation through exposed expansion points on the weathering surface of the edge.
- ✓ Protected leading edge prevents abrasion against roofing eliminating possible roof damage during service and installation.





Designed and  
manufactured  
in NZ by DLM  
from imported  
materials

Flashguard is the original soft edged roof flashing, for lock seaming to Zincalume®, galvanised or aluminium roof flashings. It replaces the traditional soft lead that was historically used on galvanised steel roof flashings. As roofing materials have changed, the requirement to meet these changes saw the design and creation of the original Flashguard soft edge by DLM over 20 years ago. This unique product expands and readily shapes snugly to the contours of the metal roofing profile, creating a waterproof barrier without scratching and damaging the paint finish of the roof.

Flashguard-z is suitable for installation over pressed metal tiles and long run metal roofing profiles, which do not exceed 32mm in height. Flashguard is available in standard sizes 43mm, 63mm, 75mm in width. If a wider strip is required (up to 103mm) this is available on request. Flashguard-vz is only available in standard 63mm width.

## Installation

1. Before placing the flashing into position, fold the Flashguard out by hand, using minimal force. Do not remove paper backing.
2. As is normal trade practice, ensure that on the top edge of the long run sheets, the pans are "turned up" to provide a stop end.
3. Affix the flashing to the roof before dressing Flashguard into the roof profile.
4. Dress the lower edge of the Flashguard into the roof profile, using finger pressure only. Start from the centre of the pan and work towards the ribs on either side.



**NO TOOLS  
REQUIRED**

## Maintenance

Flashguard should be maintained for the duration of the life of the roof. Normal rain washing will remove most of the accumulation of dirt and salt. It is recommended, as it is with the rest of the roof, that Flashguard should be cleaned with a soft bristle nylon brush and clean water at least once a year, and more often in severe environments. When installed correctly and maintained, Flashguard satisfies the 15 years durability requirement of the NZ Building Code.

\*For maintenance guide please visit our website:  
[www.dlm/flashguard.html](http://www.dlm/flashguard.html) and download the brochure.

Aluminium Mill Finish	Permanent Green
BasaltBase™	Pioneer Red
Bone White	Rivergum
Cloud	SandScape™
Dark Grey Primer	Sandstone Grey
Desert Sand	Scoria
Ebony	Slate
FernFronD™	Slate Blue
FlaxPod™	Smokey
Grey Flannel	Smooth Cream
Greyfriars	Stone
Gull Grey	Storm Blue
Ironsand	TernStyle™
Karaka	Terracotta
KowhaiGlow™	Threadbow White
Lichen	Thunder Grey
Light Grey Primer	Titania
Lignite	TuiTuft™
Mist Green	Weather Copper
New Denim Blue	Windsor Grey
Nimbus	Zinc Metallic

# Specialist Tapes

## DANCO Flashband 820/822 Flashtapes

**Self-adhesive sealing strip that bonds instantly to provide a watertight seal**

Aluminium foil backing with bituminous mastic and paper release liner. Instant, permanent and watertight, bonds to a wide range of substrates. Ideal for a wide variety of construction applications including permanent repairs to all types of gutters and flashings. Easily applied.

- ✓ Quick and easy application by hand.
- ✓ No special equipment required for cutting, forming or fixing.
- ✓ Proven performance in NZ conditions for over 30 years.
- ✓ Bonds to a wide variety of building materials.
- ✓ Provides lasting protection in all climates.

### Instructions for use:

1. Thoroughly clean and dry surfaces prior to applying flashing tape.
2. If surface is porous or crumbling, prime with Duram Bituflex.
3. Apply Flashing Tape firmly to substrate, smooth down and mould in place.
4. Overlap adjoining strips by a minimum of 25mm.
5. Application temperature 5°C to 40°C. May be warmed to aid adhesion if cold.



### Silver 820 Grey 822 Roll Sizes:

48mm x 10m  
72mm x 10m  
96mm x 10m  
150mm x 10m  
225mm x 10m  
300mm x 10m

## DANCO 830 Pure Aluminium Foil Tape

**Provides a flexible migration barrier between bituminous materials and construction sealants**

A 30 micron pure aluminium foil coated with a rubber adhesive and a paper release liner. DANCO 830 offers excellent thermal insulation and heat reflection properties. Suitable for use in the HVAC and construction markets. Ideal for sealing foil lined insulation products in fire rated areas and joining and fixing pipe/duct work.

- ✓ Fully synthetic rubber resin based adhesive.
- ✓ UV and ozone resistant.
- ✓ Excellent water vapour barrier.
- ✓ Conformable, durable and easy to work with.
- ✓ Excellent thermal reflection properties.
- ✓ High adhesion to foils for strong overlap joints.



### Roll Sizes:

48mm x 45m  
72mm x 45m



## Stop Leak Flashing Tape

**A polyester fused aluminium foil coated with thick Butyl rubber adhesive.**

Uses include repairs to roofing, guttering, downpipe or water tank tops, sealing joints around skylights, doors or adjoining building surfaces and weathersealing seams in caravans, trucks, toolsheds etc. Stop Leaks is not a permanent solution in replacing existing weather flashings on the home.

### Instructions for use:

1. Thoroughly clean and dry surfaces prior to applying flashing tape.
2. If surface is porous or crumbling, prime with Duram primeseal.
3. Apply Flashing Tape firmly to substrate, smooth down and mould in place.
4. Overlap adjoining strips by a minimum of 25mm.
5. Application temperature is 5°C to 40°C. May be warmed to aid adhesion if cold.

### Handy Pack Sizes:

50mm x 3m  
75mm x 3m

### Roll Sizes:

50mm x 10m  
75mm x 10m  
100mm x 10m  
150mm x 10m

## Leak Seal Tape

**An open weave polyester reinforced fabric tape with Butyl adhesion.**

Used for waterproofing and sealing joints, cracks and gaps in most building substrates in conjunction with waterproofing membranes.



### Instructions for use:

1. Surfaces must be even and smooth without texture, spikes or similar.
2. Peel backing paper, place Leak Seal Tape centred over joint, crack or corner with hands.
3. Overlaps should be at least 100mm.
4. Waterproofing membranes can be applied directly to Leak Seal Tape.

### Roll Size:

80mm x 15m



# COATINGS AND WATERPROOF MEMBRANES

## WATERPROOFING

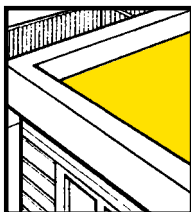

### Decks and roof terraces

- AZCOFLEX TR for trafficable areas
- White or Grey
- Available in Tintable Accent base
- Highly durable
- UV resistant

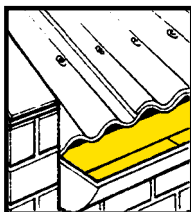

### Roofs and gutters

- AZCOTHANE REO Microfibre reinforced membrane
- Standard Grey
- Highly durable
- UV resistant

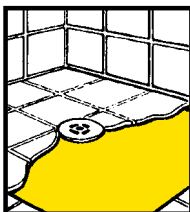

### Showers and bathrooms

- DURABIT EF Latex based Membrane
- EF (Extra Flexible)
- Non Staining (Tiles, Grout)
- Resists hydrostatic pressure

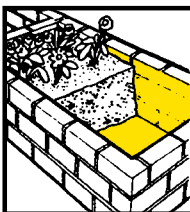

### Retaining walls and planter boxes

- DURAM 195
- Fast curing
- Permanently flexible
- Self levelling and seamless membrane

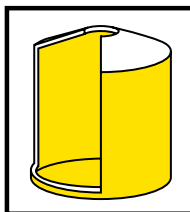

### Water tanks, ponds and water features

- CRYSTOFLEX 2 pack Cementitious + polymer Membrane sealing water tanks, ponds, pools, planter boxes internally
- CRYSTOSEAL Waterproofing by Crystallisation
- Suitable for waterproofing both the positive and negative sides of the substrate
- UV resistant

## ANTI-SLIP COATINGS

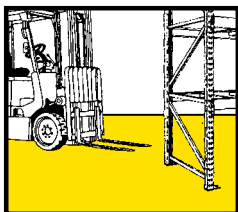

### Commercial flooring

- ROCKTUFF single pack polyurethane
- Hard wearing
- Anti slip
- Chemical resistant
- Flexible
- Available in 8 colours

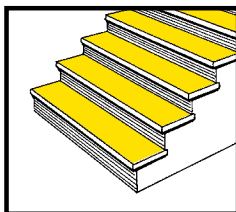

### Domestic applications

- VIROTUFF single pack water based polyurethane polymer
- Environmentally friendly
- Anti slip
- Hard wearing
- Attractive
- Available in 20 colours

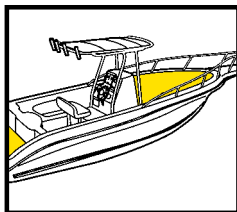

### Marine applications

- ROCKTUFF or VIROTUFF
- Boat decks and trailers
- General protective coating
- Steps and ramps
- Marinas
- Pontoons



Email: [enquiries@duram.co.nz](mailto:enquiries@duram.co.nz) Web: [www.duram.co.nz](http://www.duram.co.nz)